

[< print this page >](#)

Base Cabinets Assembly Guide

Thank you for choosing us as your cabinet provider.

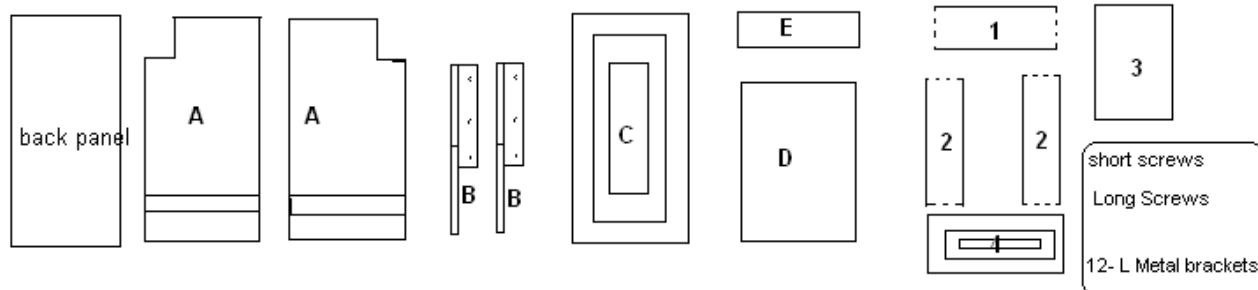
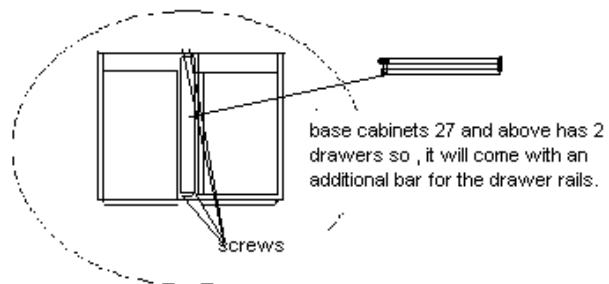

Step 1

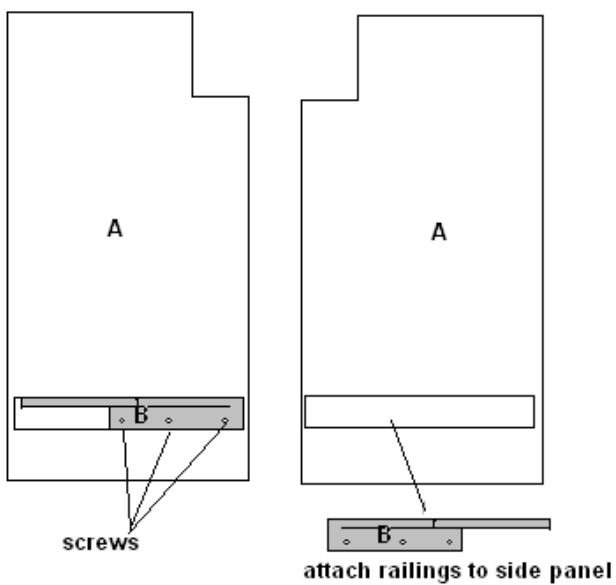

Step 2

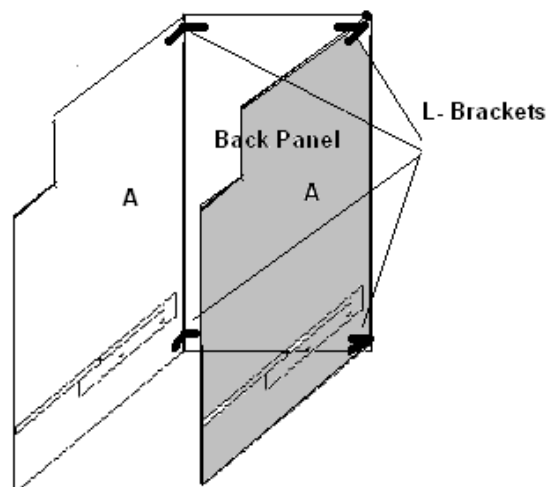

Step 3

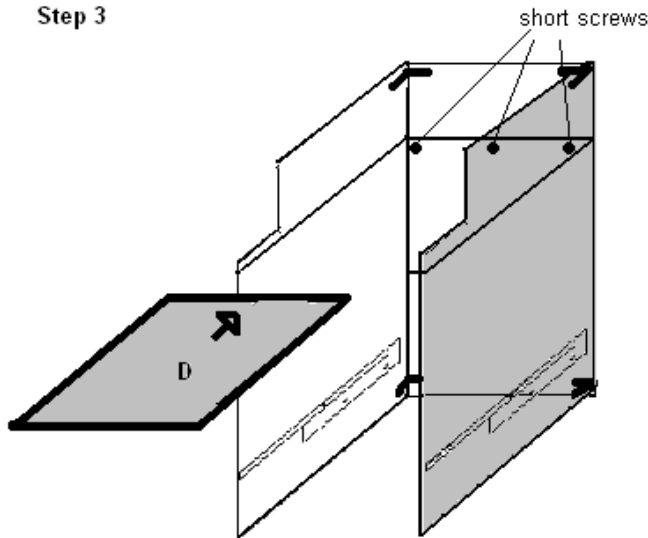

If using wood glue , fill in grooves before sliding in Panel D. If using screws slide in Panel D **first** and attach screw in position as shown

Step 4

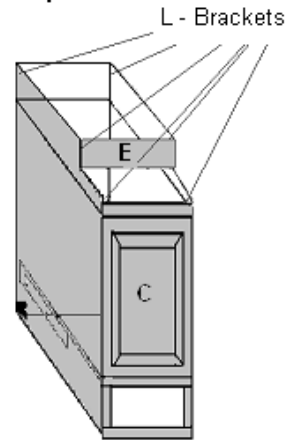

Slide in Panel E (toe kick) . and Attach Face Panel C . See diagram make sure to attach L-Brackets as shown

Step 5

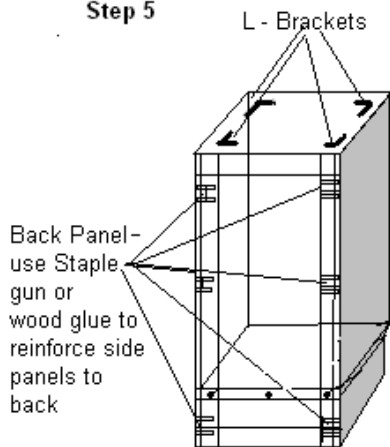

Step 6

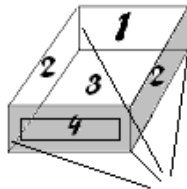

use a mallet to put dove tail drawers together. use either wood glue or staple gun to reinforce corners

Step 7

